

2<sup>nd</sup> Grade RL Units

READING:

Literature

DIGITAL GRAPHIC ORGANIZERS



Created by Jessica Tobin

# Please read!

These digital graphic organizers are the same graphic organizers from my RL2 units. They've just been recreated horizontally and put into Google slides.

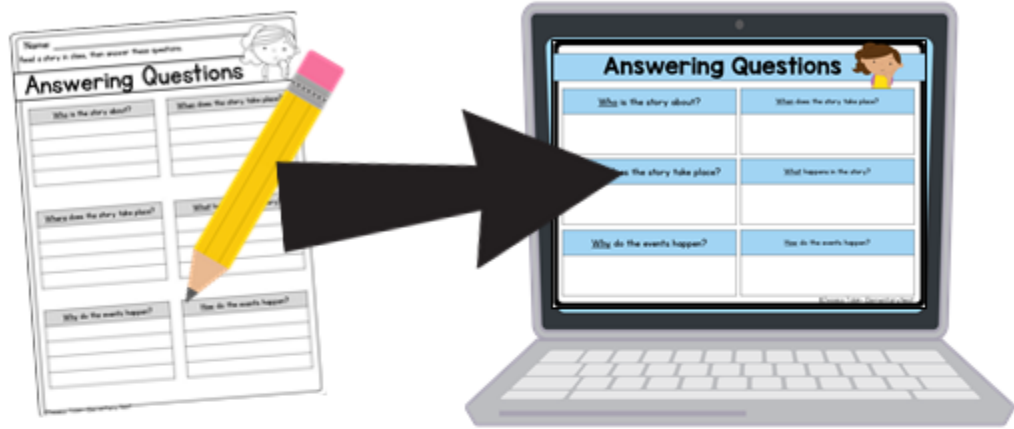

**These graphic organizers are meant to be used with Google Slides.**

To open each set of graphic organizers, click on the standard boxes on the following page. These links will open Google Slides presentations that contain between 6-12 digital graphic organizers that are specific to each standard.

## What you need:

-A Google Classroom account

## What to do:

- Open document using links on next page.
- Click "make a copy". This will be your master copy. Name it whatever you'd like.
- Make another copy to share with your students. Get the shareable link using the 'Share' button in the top right corner.

## Options for sharing:

- Copy the *specific slide* you need and share it with your students.
- Share the *entire presentation* for them to fill out by a certain date or for use when they are reading independently.
- Create a graphic organizer folder for your students to access whichever ones they want/need.

# Sample Pages

**Asking Questions**

Title:	Author:
Who	Why
What	How
Where	Did
When	Which

**Point of View**

Text: \_\_\_\_\_ Author: \_\_\_\_\_

**Character 1**

How does the character feel in the text?

**Character 2**

How does the character feel in the text?

**Recount a Folktale**

Who are the main characters? \_\_\_\_\_

Author: \_\_\_\_\_

What is the setting? \_\_\_\_\_

What happens at the beginning? \_\_\_\_\_

What happens at the end? \_\_\_\_\_

RL.2.5 Graphic Organizers

## Story Structure

Who are the characters? Type here	Describe the setting Type here
What is the character's problem? Type here	
What events happen in the story? Type here	
How does the character solve the problem? Type here	

# CLICK your standard!

**RL.2.1**

Ask & Answer  
Questions

**RL.2.2**

Recounting  
Fiction Stories

**RL.2.3**

Character  
Response

**RL.2.4**

Words &  
Phrases in  
Poetry

**RL.2.5**

Story  
Structure

**RL.2.6**

Point of View

**RL.2.7**

Illustrations in  
a Text

**RL.2.9**

Comparing and  
Contrasting

